

NOTES:

1. SPRING FORCE: 1.0 - 1.3N-cm
2. MATERIAL: TBD BY MANUFACTURER
3. No. TURNS: TBD BY MANUFACTURER
4. THICKNESS: TBD BY MANUFACTURER
5. ASSOCIATED CAD FILE: ClockSpring_Wound.STP
6. QUANTITY NOTED IN RFQ

| REVISION HISTORY | | | | |
|------------------|-----|----------------------|------------|----------|
| ZONE | REV | DESCRIPTION | DATE | APPROVED |
| | 0 | INITIAL RELEASE | 12/21/2020 | J. HAUPT |
| A2 | 1 | REVISED DEPTH & TOL. | 4/30/2021 | J. HAUPT |

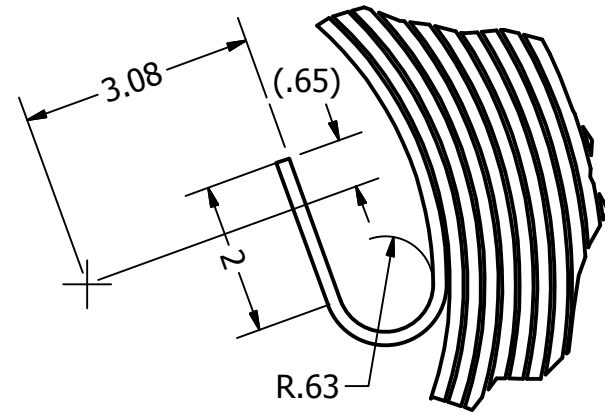

DETAIL A

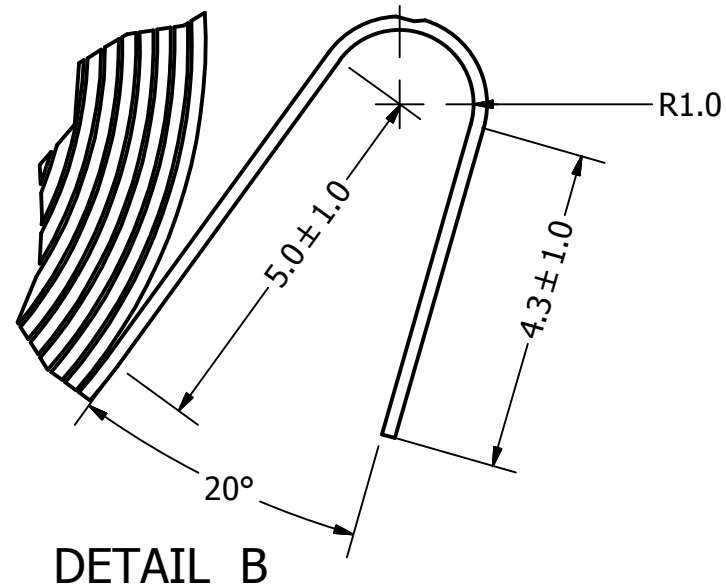

DETAIL B

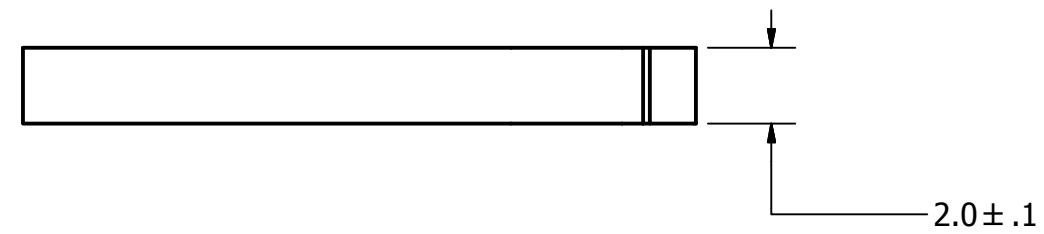
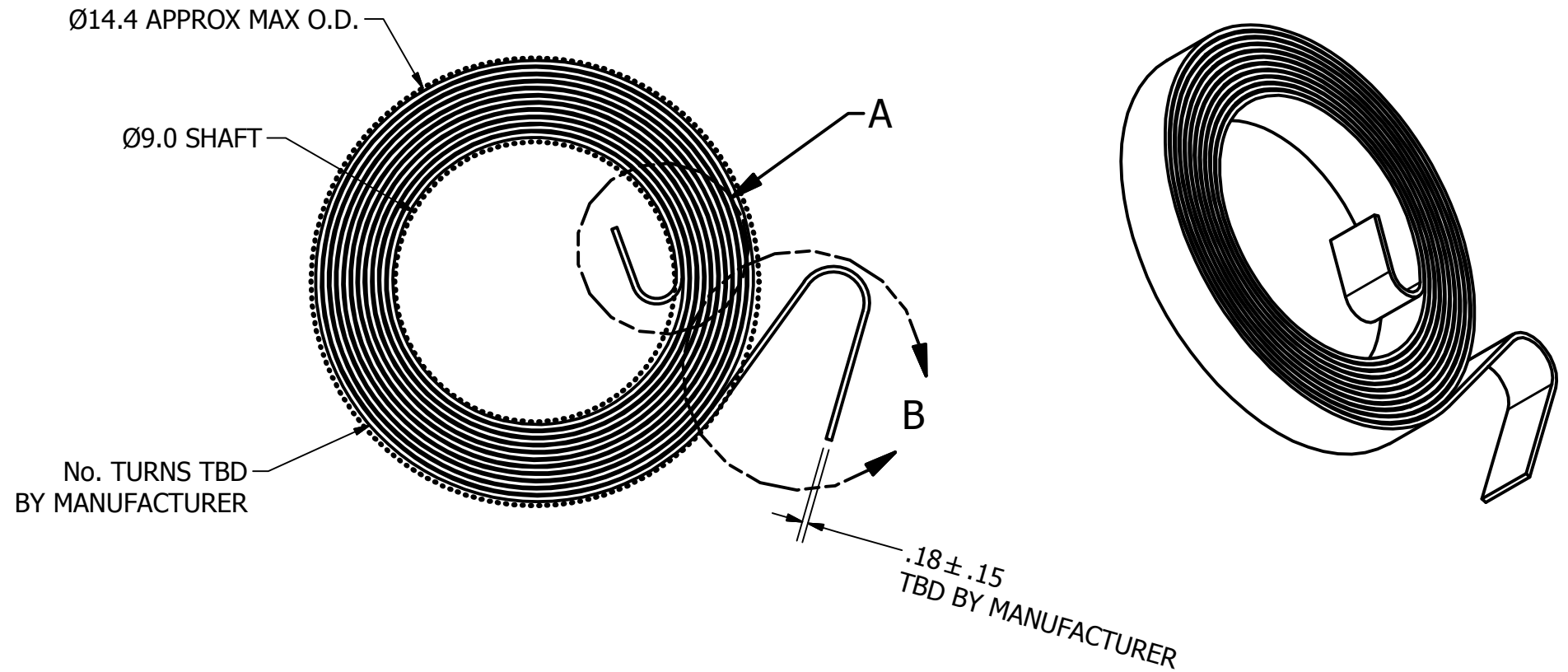

ENGINEER
Justine Haupt 12/20/2020

ALL UNITS IN MM
DECIMAL TOLERANCES:

X = ±.50
X.X = ±.30
X.XX = ±.16
X.XXX = ±.08

ALL SURFACES
Ra μm .8 ✓
UNLESS OTHERWISE NOTED

SKY'S EDGE
www.skysedge.us

(631) 965-3409
justine@skysedge.us

4GRCP CLOCK SPRING

| | | | |
|------|---------|----------|-----|
| SIZE | PROJECT | DWG NO | REV |
| B | | 4GRCPCS1 | 1 |